

Sprocket with taper-lock bush 16B-3 27 teeth

Part no.: I78265f89875b

Model: 27 teeth

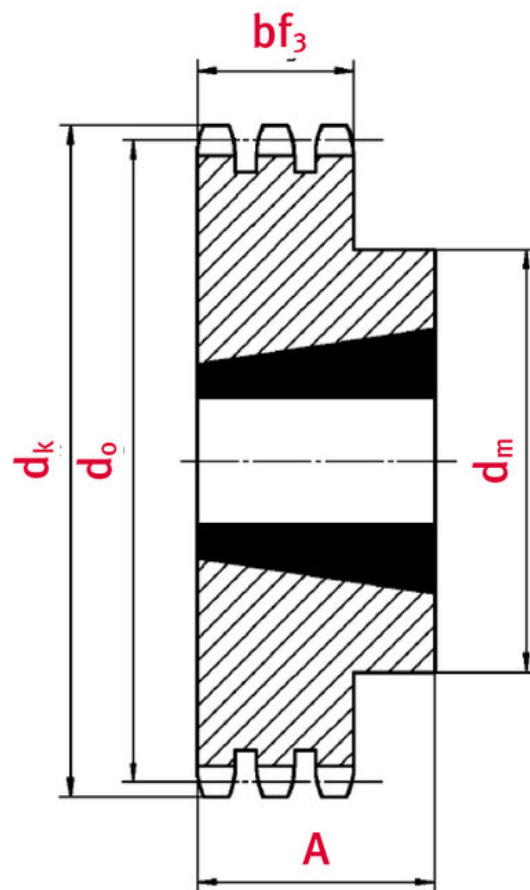

Technical data

SPROCKET	16B
Teeth	27
Tip circle dk (mm)	230,4
Total length L (mm)	89

Hub	175
Taper-lock bush (Ref.-Nr.)	3535
Sprocket type	4

Product Information

Taper-lock clamping hubs enable the precise axially-centred fixing of hubs on shafts. When used with sprockets, they offer a twofold advantage over a shaft-to-hub connection with keyways: quick fitting and better centring.

REQUEST DIRECTLY ONLINE NOW

<https://www.iwis.com/en-en/products-services/sprocket-with-taper-lock-bush-16b-3-27-teeth~p8758>

Useful information

CALCULATION PROGRAM

InduKet: the Chain Drive Calculation Program for Engineers.

[iwis.com/chaincalc](https://www.iwis.com/chaincalc)

CHAIN CALCULATION

The right drive solution for your challenge.

chaindrive@iwis.com

SERVICES

ChainFinder, CAD data, iwis Chain Handbook and more.

[iwis.com/services](https://www.iwis.com/services)