

iwis

wir bewegen die welt



NEW

Rapid Service for Conveyor Chains

The new Rapid Service from iwis Suzhou for the Asian market: the **fast, flexible conveyor chain range** for delivery of selected chain types at short notice. MEGAlife maintenance-free versions also available. Conveyor chains **with customer-specific special attachments** can now also be produced in small quantities quickly and at short notice without compromising the accustomed high chain quality standards! Only iwis can offer this.

BEST OF
GERMAN
ENGINEERING

www.iwis.com



Express production for fast-track chains

NEW

Rapid Service for Conveyor Chains

Rapid Service

iwis has set up new production lines in Asia to offer you more flexibility when you need roller chains with attachments at short notice.

The new production lines enable us to offer extra-short lead times and a high level of flexibility for small quantities of standard roller chains with bent or straight attachment plates and roller chains with elongated pins.

Highlights

- **Fastest delivery times**
- **Highest flexibility** for our rapid service conveyor chains program
- **Chains types:** conveyor chains with straight and bent attachment plate, as well as conveyor chains with extended bearing pins
- Delivery scope: chain sizes **08B-1 to 16B-1** and **ANSI 40-1 to ANSI 80-1**
- Delivery time for standard versions: at short notice following request

Exclusive

Conveyor chains with customer-specific special attachments can now also be produced in small quantities quickly and at short notice without compromising the accustomed high chains quality standards! **Only iwis can offer this.**

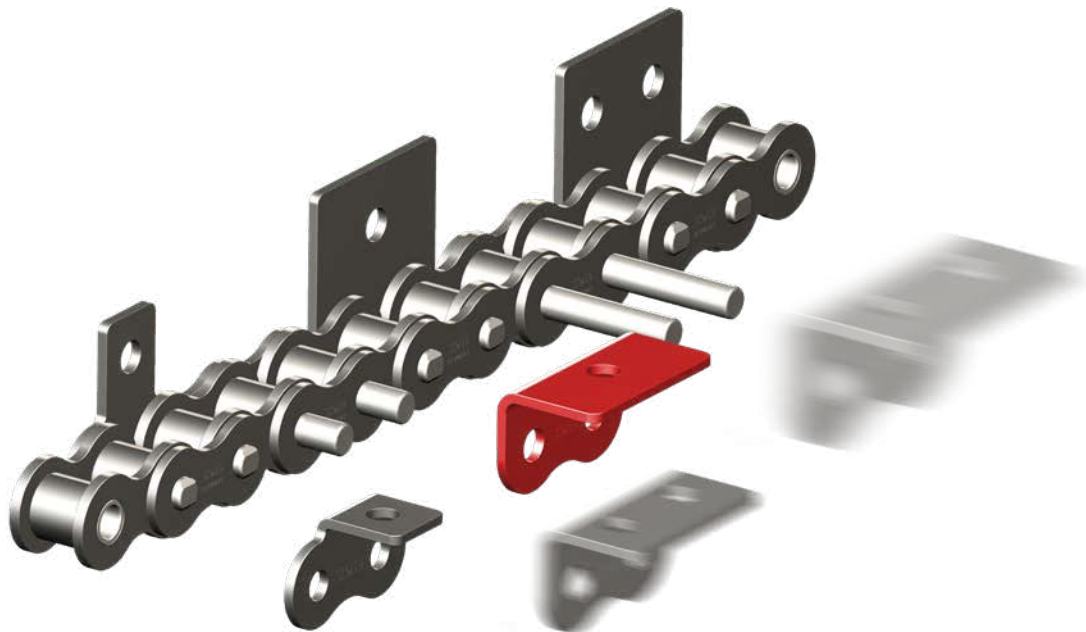

Straight attachments for roller chains according to ISO 606 (M-Series)

Chain type	Pitch	Inner width	Inner link width	Roller diameter	Plate height	Breaking strength	l	a	d	S	i	b
	p mm	b1 min. mm	b2 max. mm	d1 max. mm	g max. mm	DIN min(N)	mm	mm	mm	mm	mm	mm
08B-1-M1	12,7	7,75	11,3	8,51	11,81	18	9,5	13	4,5	1,5	-	18,9
10B-1-M1	15,875	9,65	13,28	10,16	14,73	22,4	14,3	16,5	5,3	1,7	-	22,95
12B-1-M1	19,05	11,68	15,62	12,07	16,1	29	16	21	6,4	1,7	-	28,6
16B-1-M1	25,4	17,02	25,45	15,88	21,08	60	19,1	23	6,4	1,8	-	34
40-1-M1	12,7	7,85	11,17	7,92	12,07	13,91	9,5	12,7	3,6	1,5	-	17,5
50-1-M1	15,875	9,4	13,84	10,16	15,09	21,85	12,7	15,88	5,2	2	-	22,6
60-1-M1	19,05	12,57	17,75	11,91	18	39,5	15,9	18,26	5,2	2,35	-	26,2
80-1-M1	25,4	15,75	22,6	15,88	24,13	55,66	19,05	24,6	6,8	3,2	-	34

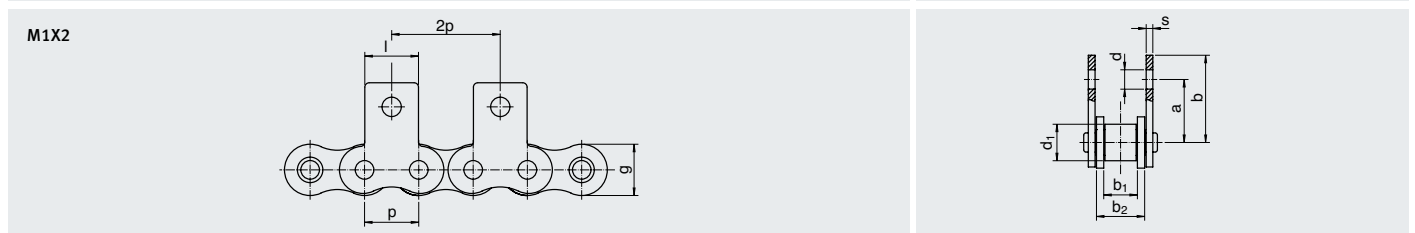
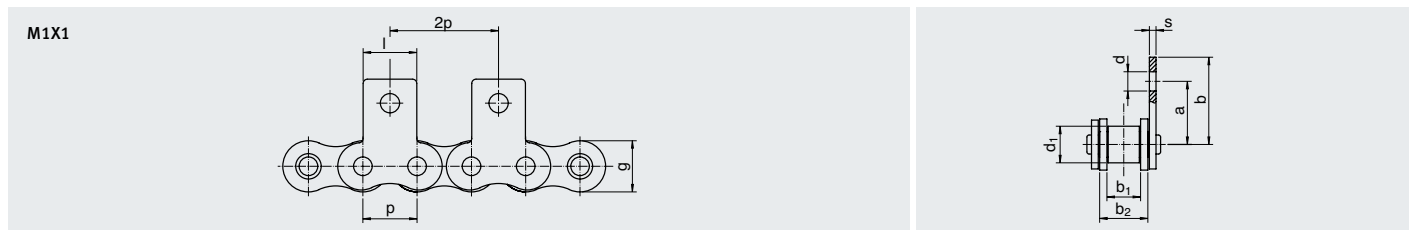

Chain type	Pitch	Inner width	Inner link width	Roller diameter	Plate height	Breaking strength	l	k	d	S	i	b
	p mm	b1 min. mm	b2 max. mm	d1 max. mm	g max. mm	DIN min(N)	mm	mm	mm	mm	mm	mm
08B-1-M2	12,7	7,75	11,3	8,51	11,81	18	23,3	13	4,3	1,5	12,7	18,9
10B-1-M2	15,875	9,65	13,28	10,16	14,73	22,4	29,58	16,5	5,3	1,7	15,88	22,95
12B-1-M2	19,05	11,68	15,62	12,07	16,1	29	36,07	18,18	6,5	1,7	19,05	26,34
16B-1-M2	25,4	17,02	25,45	15,88	21,08	60	46,4	23	6,4	1,8	25,4	34
40-1-M2	12,7	7,85	11,17	7,92	12,07	13,91	22,9	12,7	3,4	1,5	12,7	17,4
50-1-M2	15,875	9,4	13,84	10,16	15,09	21,85	28,85	15,9	5,5	2	15,88	23,05
60-1-M2	19,05	12,57	17,75	11,91	18	39,5	34,2	18,3	6,6	2,35	19,05	28,2
80-1-M2	25,4	15,75	22,6	15,88	24,13	55,66	46	24,6	6,8	3,2	25,4	34,25

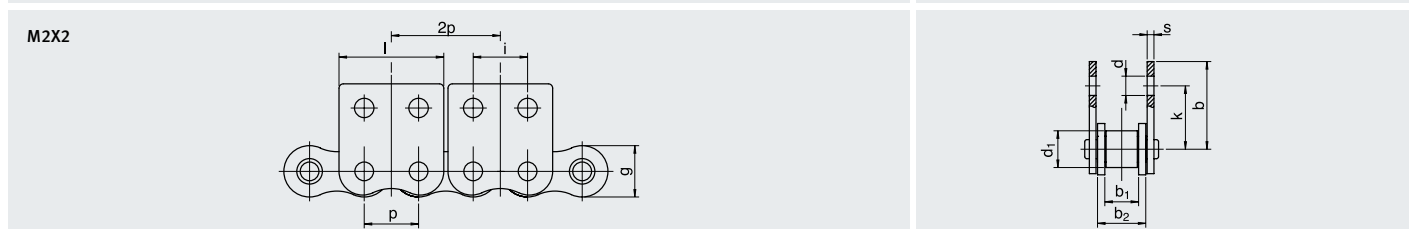
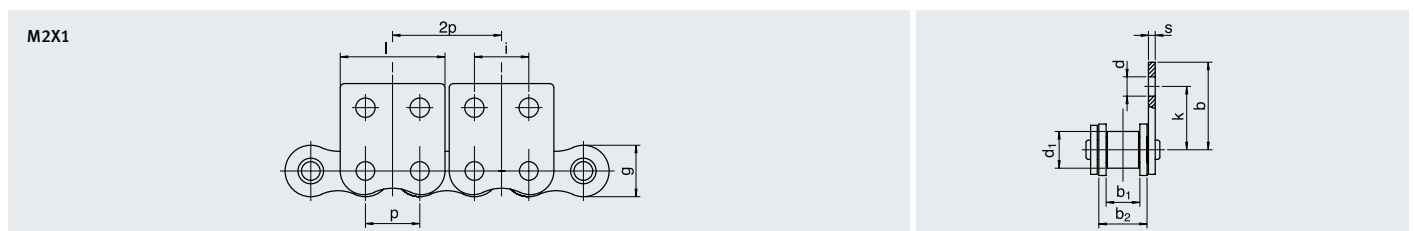

Bent attachment for roller chains according to ISO 606 (K-Series)

Chain type	Pitch	Inner width	Inner link width	Roller diameter	Plate height	Breaking strength	e1	c	d	T	i	l	f
	p mm	b1 min. mm	b2 max. mm	d1 max. mm	g max. mm	DIN min(N)	mm	mm	mm	mm	mm	mm	mm
08B-1-K1	12,7	7,75	11,3	8,51	11,81	18	12,7	8,9	4,4	1,5	-	9,5	18,5
10B-1-K1	15,875	9,65	13,28	10,16	14,73	22,4	15,9	10,3	5,3	1,7	-	14,3	22,3
12B-1-K1	19,05	11,68	15,62	12,07	16,1	29	19,05	13,5	6,4	1,8	-	16	26,1
16B-1-K1	25,4	17,02	25,45	15,88	21,08	60	25,4	15,9	6,4	4.0/3.0	-	19,1	36,3
40-1-K1	12,7	7,85	11,17	7,92	12,07	13,91	12,7	7,92	3,6	1,5	-	9,5	17,5
50-1-K1	15,875	9,4	13,84	10,16	15,09	21,85	15,9	10,3	5,2	2	-	12,7	22,8
60-1-K1	19,05	12,57	17,75	11,91	18	39,5	19	11,9	5,2	2,35	-	16,1	27,5
80-1-K1	25,4	15,75	22,6	15,88	24,13	55,66	25,4	15,9	6,8	3,2	-	19,05	35

K1X1

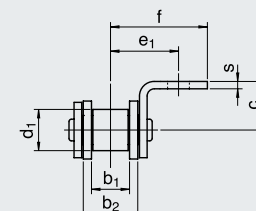
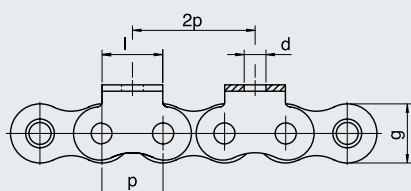

K1X2

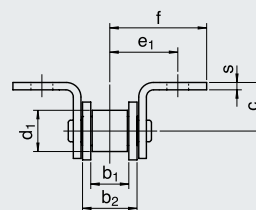
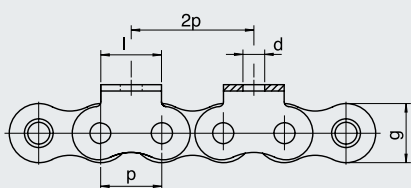

Chain type	Pitch	Inner width	Inner link width	Roller diameter	Plate height	Breaking strength	e1	c	d	T	i	l	f
	p mm	b1 min. mm	b2 max. mm	d1 max. mm	g max. mm	DIN min(N)	mm	mm	mm	mm	mm	mm	mm
08B-1-K2	12,7	7,75	11,3	8,51	11,81	18	12,7	8,9	4,4	1,5	12,7	23,18	18,25
10B-1-K2	15,875	9,65	13,28	10,16	14,73	22,4	15,9	10,3	5,3	1,7	15,875	29,58	22,3
12B-1-K2	19,05	11,68	15,62	12,07	16,1	29	19,05	13,5	6,4	1,8	19,05	34,05	26,2
16B-1-K2	25,4	17,02	25,45	15,88	21,08	60	25,4	15,9	6,4	4.0/3.0	25,4	46,4	36,3
40-1-K2	12,7	7,85	11,17	7,92	12,07	13,91	12,7	7,9	3,4	1,5	12,7	22,9	17,75
50-1-K2	15,875	9,4	13,84	10,16	15,09	21,85	15,9	10,3	5,5	2	15,875	28,85	23,3
60-1-K2	19,05	12,57	17,75	11,91	18	39,5	19	11,9	5,2	2,35	19,05	34,2	28,2
80-1-K2	25,4	15,75	22,6	15,88	24,13	55,66	25,4	15,9	6,8	3,2	25,4	46	35

K2X1

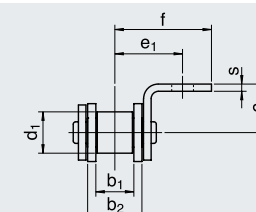
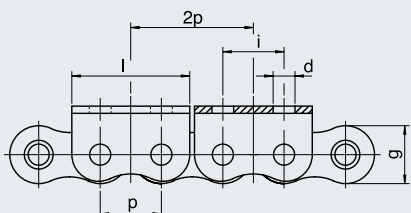

K2X2

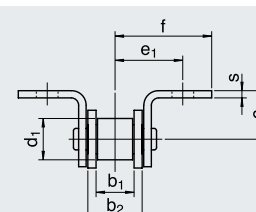
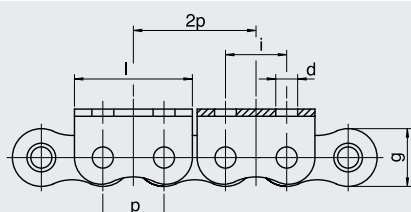

Roller chains with extendend pins according to ISO 606

Chain type	Pitch	Width between inner plates	Pin \varnothing	Length duplex pins			Length triplex pins		
				b1 min. mm	d2 max. mm	b5 max. mm	b8 max. mm	b11 max. mm	b5 max. mm
ISO	p mm	b1 min. mm	d2 max. mm	b5 max. mm	b8 max. mm	b11 max. mm	b5 max. mm	b8 max. mm	b11 max. mm
08B	12,7	7,75	3,28	31	15,5	8,2	45	29,6	15,3
10B	15,875	9,65	4,45	36,3	18,5	9,8	53	35	18,2
12B	19,05	11,68	5,08	42,2	21,5	11,4	62,2	41,2	21,4
16B	25,4	17,02	5,72	68	34,5	18	99,6	65,2	33,7
40	12,7	7,85	3,98	31	15,5	8,2	45	29,6	15,3
50	15,875	9,4	5,09	36,3	18,5	9,8	53	35	18,2
60	19,05	12,57	26,9	42,2	21,5	11,4	62,2	41,2	21,4
80	25,4	15,75	33,5	68	34,5	18	99,6	65,2	33,7

Roller chains with extended pins are manufactured with the pitch corrected at the outer link. In some cases, this pitch correction must be taken into account when manufacturing attachments. Please contact us for details of exact pitch dimensions.

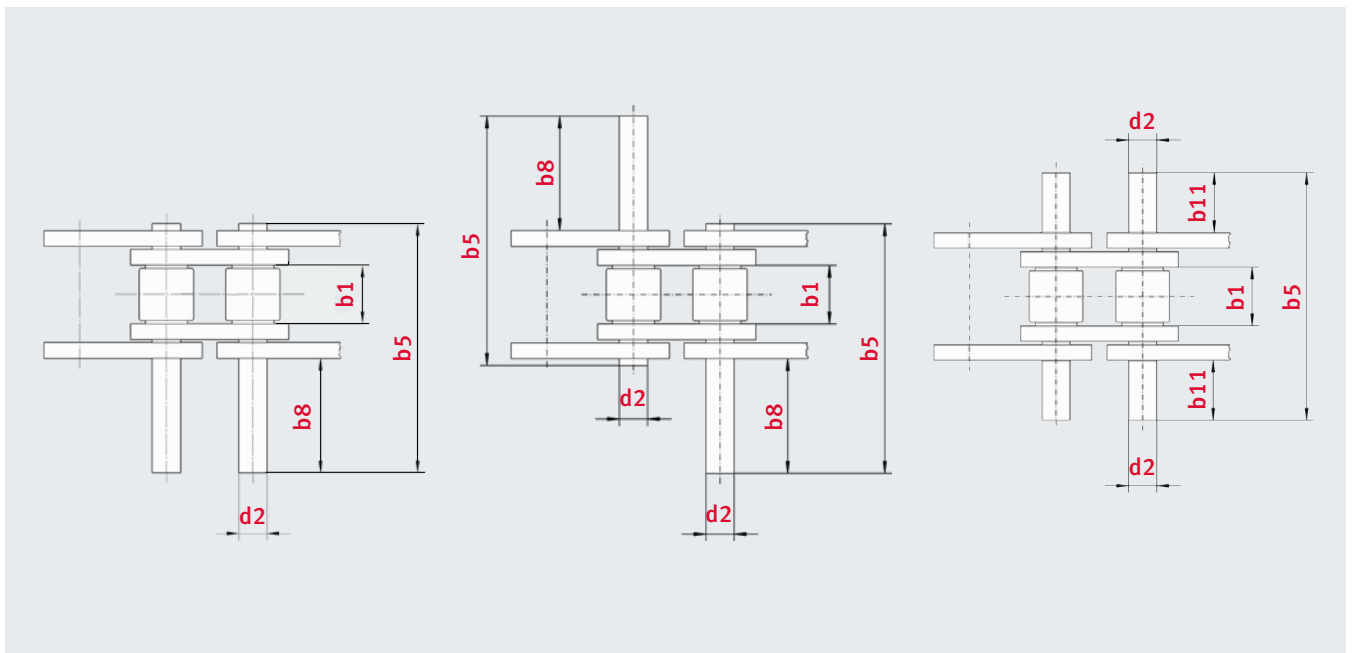



iwis

wir bewegen die welt

iwis drive systems (Suzhou) Co., Ltd.

No. 266 LvliangShan Road

215153 Suzhou SND

Tel. +86 512 8566-3020

salescn@iwis.com

www.iwis.com